

Report To: ENVIRONMENT & REGENERATION COMMITTEE **Date:** 7 March 2019

Report By: CORPORATE DIRECTOR, ENVIRONMENT, REGENERATION & RESOURCES **Report No:** LP/013/19

Contact Officer: LINDSAY CARRICK **Contact No:** 01475 712114

Subject: PROPOSED TRAFFIC REGULATION ORDER – DISABLED PERSONS’ PARKING PLACES (ON STREET) ORDER NO. 4 2018

1.0 PURPOSE

- 1.1 Local Authorities are empowered to make Orders under the Road Traffic Regulation Act 1984 as amended and under the Council’s Scheme of Administration the Head of Environmental and Public Protection is responsible for the making, implementation and review of Traffic Management Orders and Traffic Regulation Orders.
- 1.2 The purpose of the report is to introduce the proposed Traffic Regulation Order – The Inverclyde Council Disabled Persons’ Parking Places (On-Street) Order No. 4 2018.

2.0 SUMMARY

- 2.1 In order to comply with The Disabled Persons’ Parking Places (Scotland) Act 2009, Section 5, it is proposed to introduce a Traffic Regulation Order to accompany the provision of parking places for the disabled. This will restrict parking to drivers displaying a Disabled Person’s Badge only and will enable enforcement of such restrictions. The proposed Order will also revoke those parking places no longer required in order to maximise street parking capacity.
- 2.2 The provision of on-street parking places for use by disabled drivers, who are the holders of a Disabled Person’s Badge, is regulated by The Disabled Persons’ Parking Places (Scotland) Act 2009. Inverclyde Council is required to promote a Traffic Regulation Order to regulate the use of such parking places.

3.0 RECOMMENDATION

- 3.1 That the Committee recommend to the Inverclyde Council the making of the Traffic Regulation Order – Disabled Persons’ Parking Places (On-Street) Order No. 4 2018 and remit it to the Head of Service – Roads and Transportation and the Head of Legal and Property Services to arrange for its implementation.

Gerard Malone
Head of Legal and Property Services

4.0 BACKGROUND

- 4.1 There are currently no Traffic Regulation Orders that exist at the locations shown in the schedule which would prohibit the allocation of parking places for Disabled Person's Badge holders.
- 4.2 No objection has been received to the proposed Order.
- 4.3 The Committee is asked to note that, if approved, the Order may not be implemented until the making of the Order has been advertised to allow any persons who so wish a period of six weeks to question the validity of the Order in terms of the Road Traffic Regulation Act 1984.

5.0 IMPLICATIONS

Finance

- 5.1 There are no financial implications arising from this report.

Legal

- 5.2 There are no legal implications arising from this report.

Human Resources

- 5.3 There are no HR implications arising from this report.

Equalities

- 5.4 There are no equalities implications arising from this report.

Repopulation

- 5.5 There are no repopulation implications arising from this report.

6.0 CONSULTATIONS

- 6.1 The proposals have been advertised in the Greenock Telegraph and full details of the proposals have been made available for public inspection during normal office hours at the offices of the Head of Environmental and Public Protection, the Head of Legal and Property Services and at Central, Port Glasgow, Southwest and Gourock Libraries. A copy of the draft Order is appended hereto for Members' information. Appendix 1

7.0 LIST OF BACKGROUND PAPERS

- 7.1 None

THE INVERCLYDE COUNCIL
DISABLED PERSONS' PARKING PLACES
(ON-STREET) ORDER NO. 4 2018
TRAFFIC REGULATION ORDER

THE INVERCLYDE COUNCIL
DISABLED PERSONS' PARKING PLACES (ON-STREET)
ORDER NO. 4 2018

The Inverclyde Council in exercise of the powers conferred on them by Section 32(1) of the Road Traffic Regulation Act 1984 ("the Act") and of all other enabling powers and after consultation with the Chief Constable of Police Scotland in accordance with Part III of Schedule 9 to the Act hereby make the following Order.

1. This Order may be cited as "The Inverclyde Council Disabled Persons' Parking Places (On-Street) Order No. 4 2018" and shall come into operation on ????????

2. In this Order the following expressions have the meanings hereby assigned to them:-

"Council" means The Inverclyde Council or its successors as Roads Authority;

"disabled person's badge" means:

- (a) a badge issued under Section 21 of the Chronically Sick and Disabled Persons Act 1970 (as amended);
 - (b) a badge issued under a provision of the law of Northern Ireland corresponding to that section; or
 - (c) a badge issued by any member State other than the United Kingdom for purposes corresponding to the purposes for which badges under that section are issued;
- and which has not ceased to be in force;

"disabled person's vehicle" means a vehicle lawfully displaying a disabled person's badge;

"parking attendant" means a person employed in accordance with Section 63A of the Act to carry out the functions therein;

"parking place" means an area of land specified by number and name in Columns 1 and 2 in the Schedule to this Order;

"traffic sign" means a sign prescribed or authorised under Section 64 of the Act; and

"vehicle" unless the context otherwise requires, means a vehicle of any description and includes a machine or implement of any kind drawn or propelled along roads whether or not by mechanical power.

3. The Schedule titled "Disabled Persons' Parking Places (On Street) Order No. 4 2018" forms the Schedule to this Order.
4. Each area of road which is described in the Schedule Part 1 to this Order and the plans relative to this Order is hereby designated as a parking place.
5. The parking places shall only be used for the leaving of disabled persons' vehicles displaying a valid disabled person's badge.

6. The limits of each parking place shall be indicated on the carriageway as prescribed by The Traffic Signs Regulations and General Directions 2016, as amended.
7. Every vehicle left in any parking place shall stand such that no parking place is occupied by more than one vehicle and that every part of the vehicle is within the limits of the parking place provided that, where the length of a vehicle precludes compliance with this paragraph, such vehicle shall be deemed to be within the limits of a parking place if:-

the extreme front portion or, as the case may be, the extreme rear portion of the vehicle is within 300mm of an indication on the carriageway provided under this Order in relation to the parking place; and

the vehicle, or any part thereof, is not within the limits of any adjoining parking place.
8. Any person duly authorised by the Council or a police officer in uniform or a traffic warden or parking attendant may move or cause to be moved in case of any emergency, to any place they think fit, vehicles left in a parking place.
9. Any person duly authorised by the Council may suspend the use of a parking place or any part thereof whenever such suspension is considered reasonably necessary:-

for the purpose of facilitating the movement of traffic or promoting its safety;

for the purpose of any building operation, demolition, or excavation in or adjacent to the parking place or the laying, erection, alteration, removal or repair in or adjacent to the parking place of any sewer or of any main, pipe, apparatus for the supply of gas, water electricity or of any telecommunications apparatus, traffic sign or parking meter;

for the convenience of occupiers of premises adjacent to the parking place on any occasion of the removal of furniture from one office or dwellinghouse to another or the removal of furniture from such premises to a depository or to such premises from a depository;

on any occasion on which it is likely by reason of some special attraction that any street will be thronged or obstructed; or

for the convenience of occupiers of premises adjacent to the parking place at times of weddings or funerals or on other special occasions.
10. A police officer in uniform may suspend for not longer than twenty four hours the use of a parking place or part thereof whenever such suspension is considered reasonably necessary for the purpose of facilitating the movement of traffic or promoting its safety.

11. This Order insofar as it relates to the parking places to be revoked (R) and amended, as specified in the Schedule Part 2 to this Order, partially revokes and amends The Inverclyde Council Disabled Persons' Parking Places (On-Street) Order Nos. 01/2001, 01/2004, 03/2007, 02/2008, 04/2010, 01/2011, 03/2011, 01/2014, 02/2015 and 01/2018 respectively.

Sealed with the Common Seal of The Inverclyde Council and subscribed for them and on their behalf by ??????????, Proper Officer, on the ???????? day of ??????, Two Thousand and ????????

DRAFT

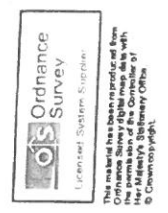
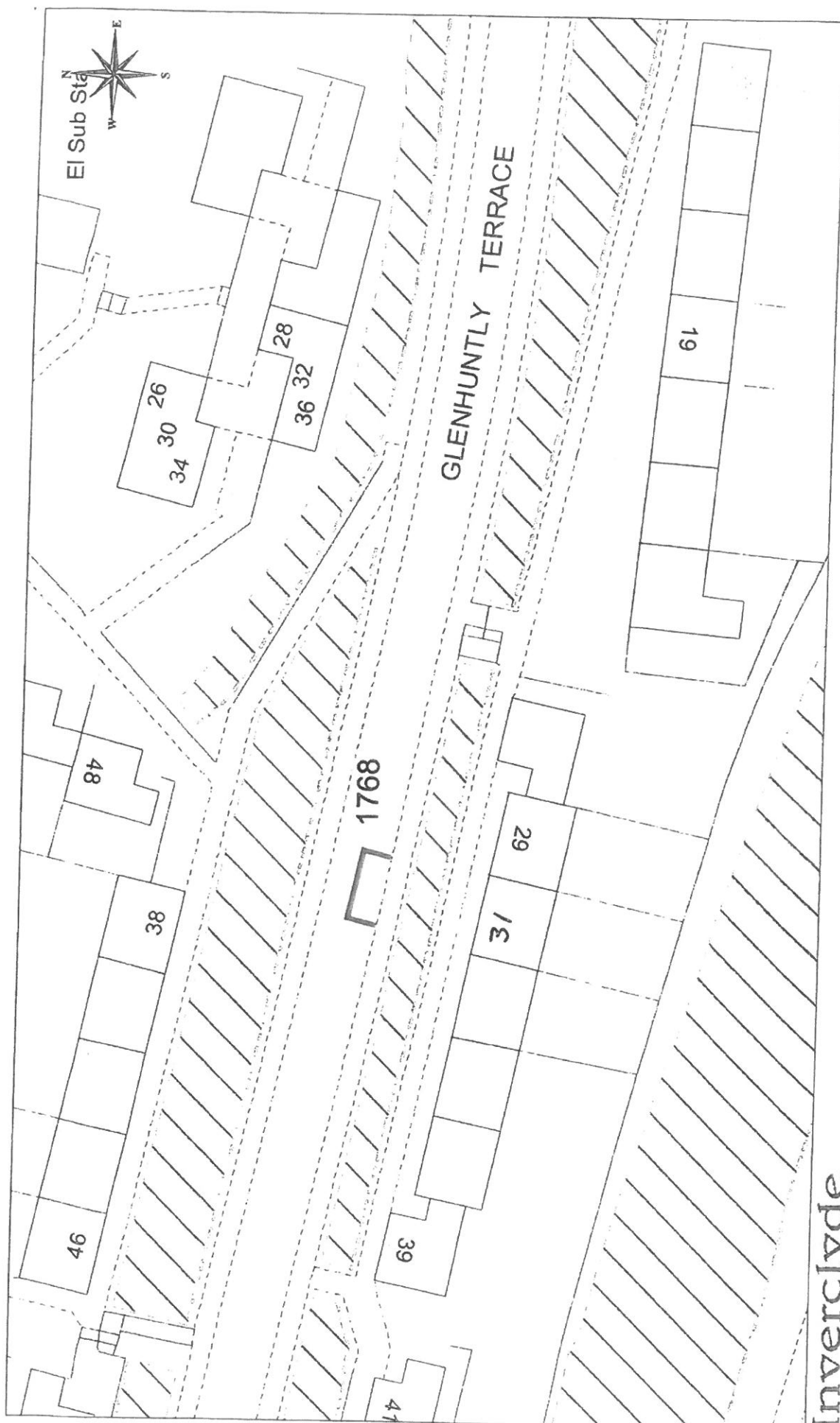

Inverclyde
council
 Environmental and Commercial Services

Environment, Regeneration & Resources
 Corporate Director: Scott Allan BSc., C.Eng., M.I.C.E.
 Municipal Buildings
 Cyba Square
 Central Inverclyde
 PA15 1LX
 Tel: 01475 712712
 Fax: 01475 712731
scott.allan@inverclyde.gov.uk

DISABLED PERSONS' PARKING PLACE
 31 GLENHUNTLY TERRACE, PORT GLASGOW
 PLACE No. 1768

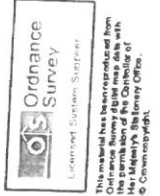
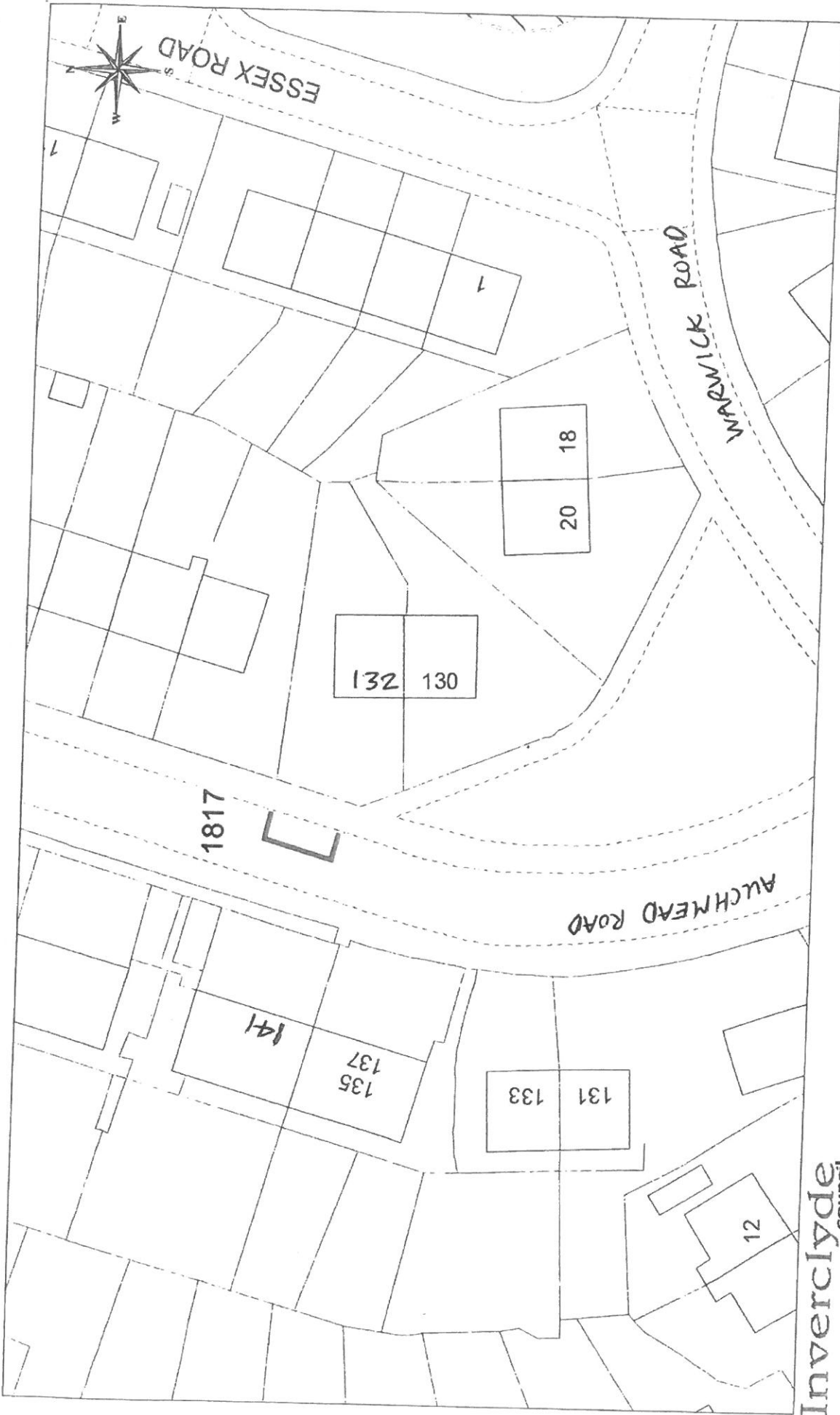

DISABLED PERSONS' PARKING PLACE
 132 AUCHMEAD ROAD, GREENOCK
 PLACE No. 1817

Inverclyde Council
 Environmental and Commercial Services
 Environment, Regeneration & Resources
 Corporate Director: Scott Allan BSc., C.Eng., M.I.C.E.
 Municipal Buildings
 Cycle Square
 Greenock
 PA15 1LY
 Tel: 01475 712712
 Fax: 01475 712731
 scott.allan@inverclyde.gov.uk

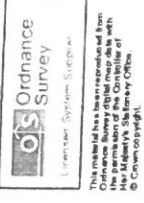
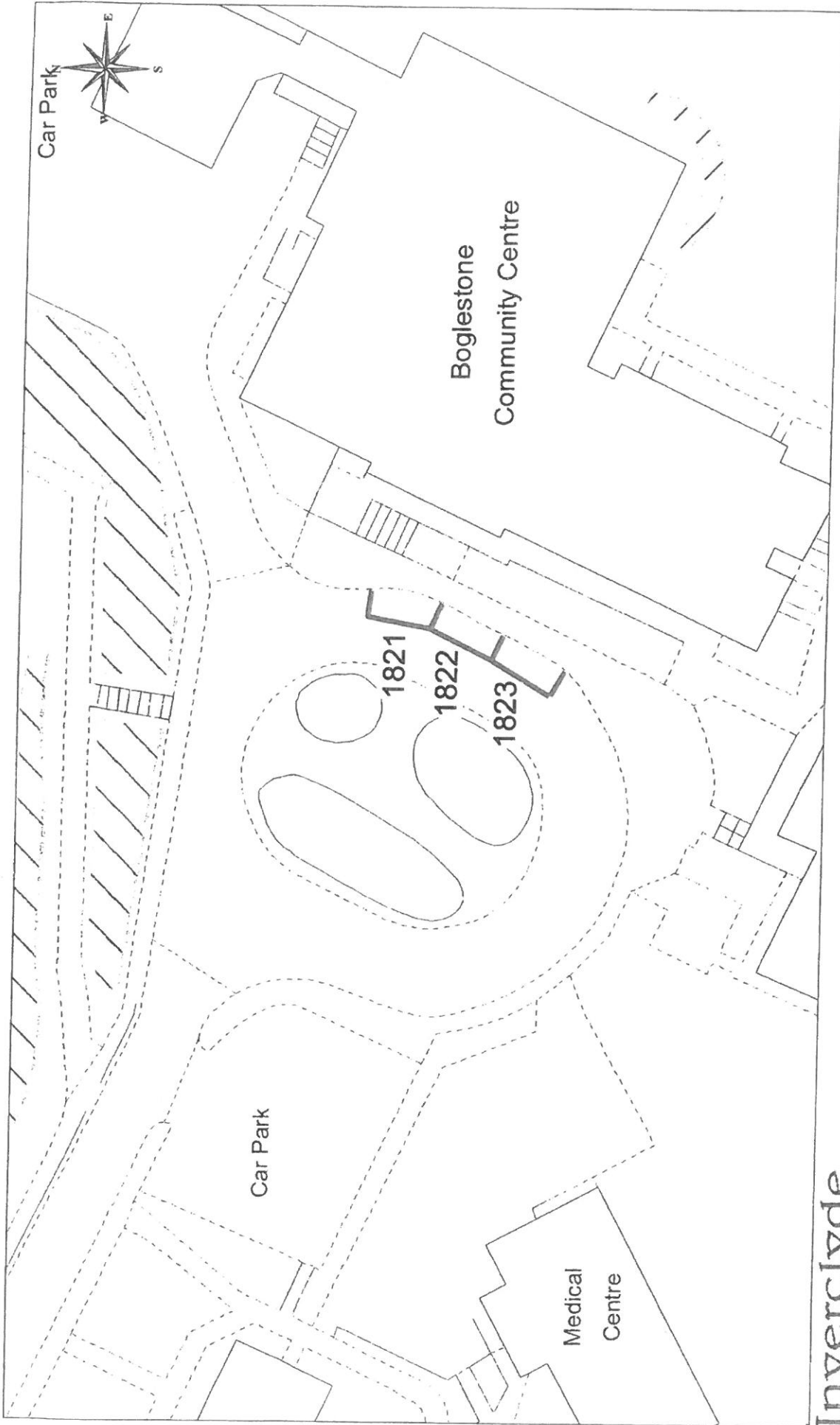

DISABLED PERSONS' PARKING PLACE
DUBBS PLACE, PORT GLASGOW
PLACES Nos. 1821-1823

Inverclyde Council
 Environmental and Commercial Services
 Environment, Regeneration & Resources
 Corporate Director: Scott Allen BSc., C.Eng., M.I.C.E.
 Municipal Buildings
 Clyde Square
 PA15 1JY
 Tel: 01475 712712
 Fax: 01475 712731
 scott.allan@inverclyde.gov.uk

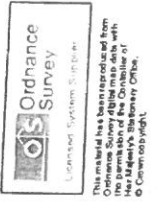
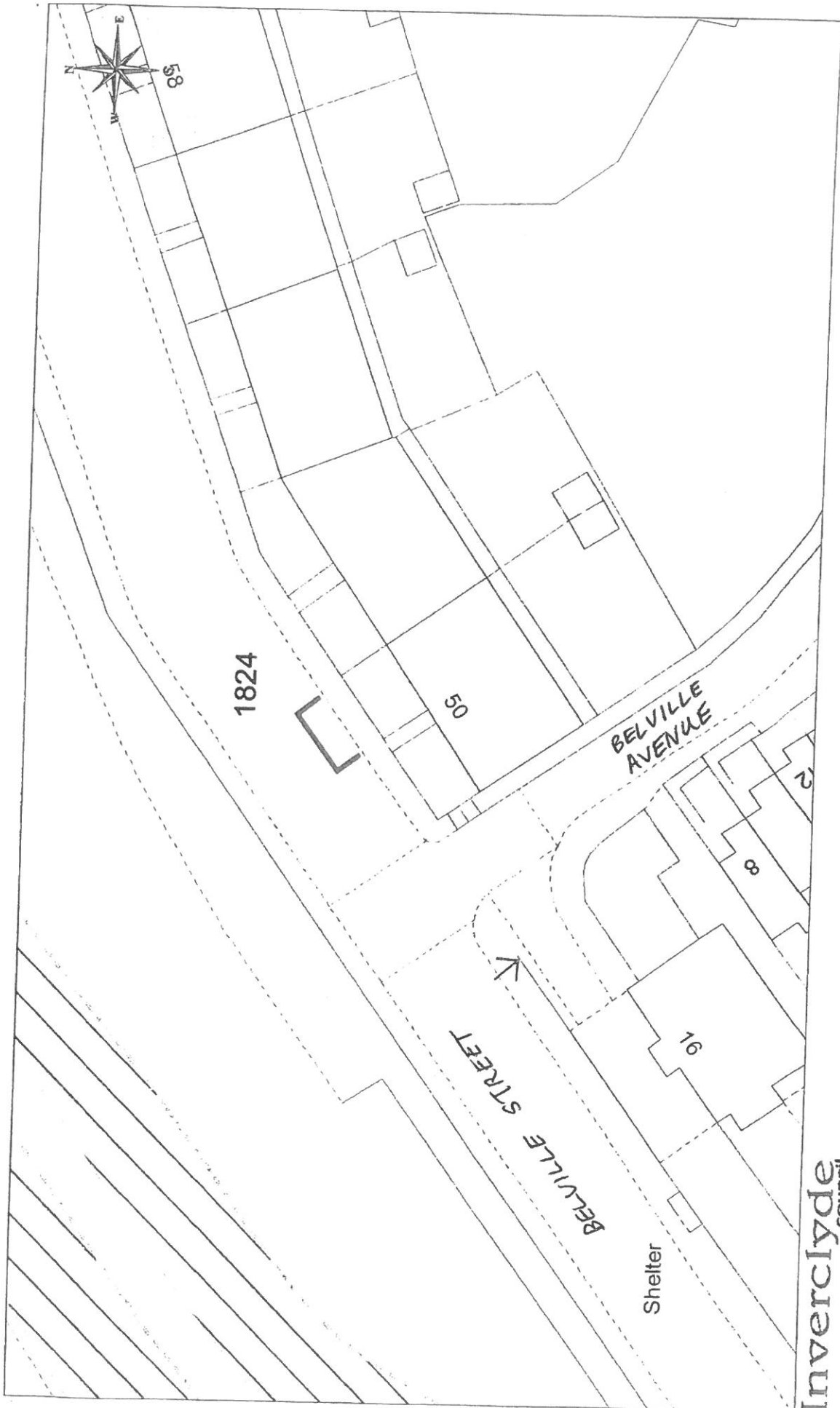

DISABLED PERSONS' PARKING PLACE
50 BELVILLE STREET, GREENOCK
PLACE NO. 1824

Inverclyde Council
 Environmental and Commercial Services
 Environment, Regeneration & Resources
 Corporate Director: Scott Allan BSc., C.Eng., M.I.C.E.
 Municipal Buildings
 Civic Square
 Greenock
 PA15 1LY
 Tel: 01475 712712
 Fax: 01475 712731
 scott.allan@inverclyde.gov.uk

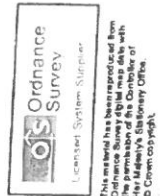
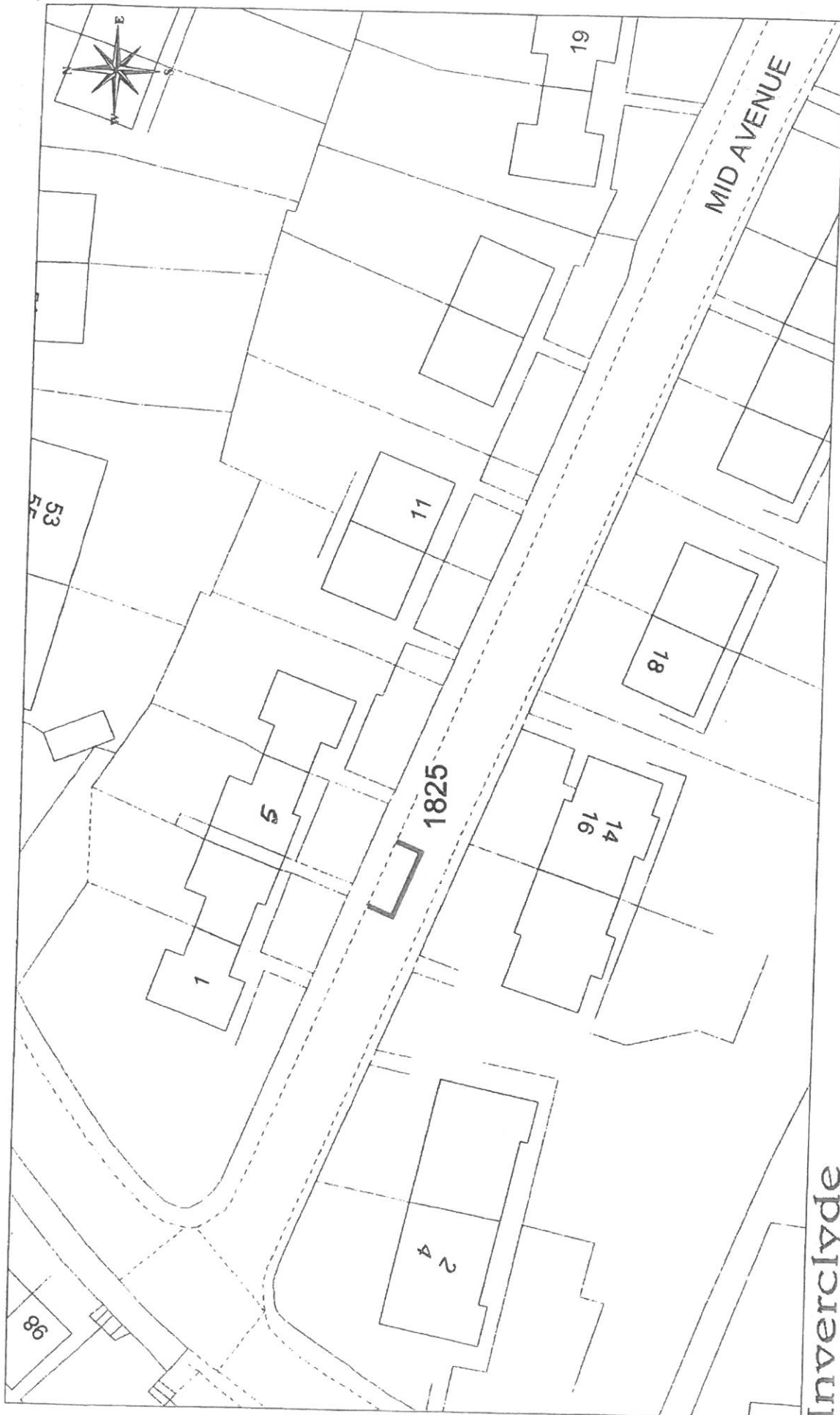

DISABLED PERSONS' PARKING PLACE
 5 MID AVENUE, PORT GLASGOW
 PLACE No. 1825

Inverclyde
 council
 Environmental and Commercial Services
 Environment, Regeneration & Resources
 Corporate Director: Scott Alan BSc., C.Eng., M.I.C.E.
 Municipal Buildings
 Clyde Square
 Greenock
 PA15 1LY
 Tel: 01475 712712
 Fax: 01475 712731
 scott.allan@inverclyde.gov.uk

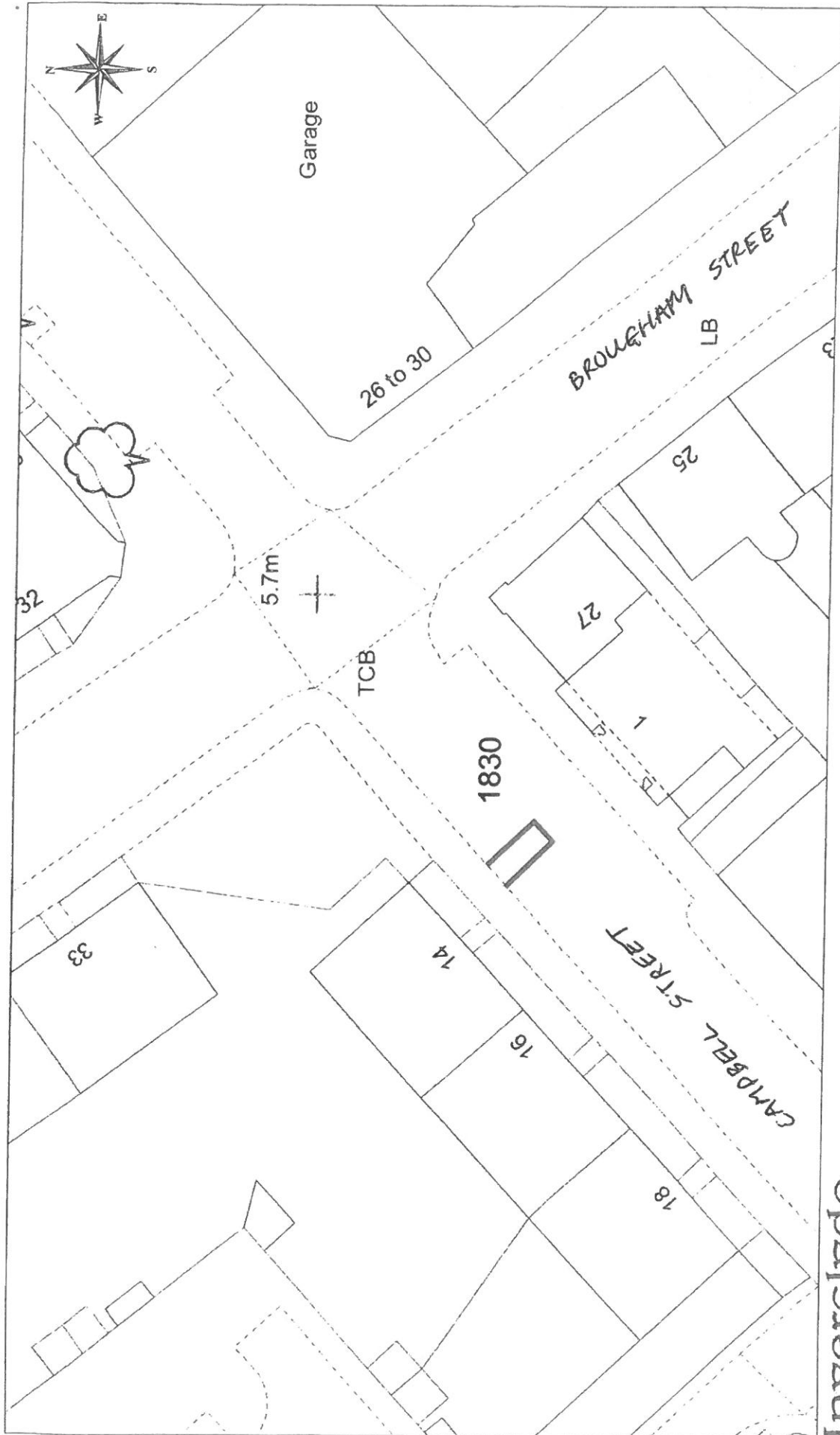

DISABLED PERSONS' PARKING PLACE
14 CAMPBELL STREET, GREENOCK
PLACE No. 1830

Inverclyde
 council

Environmental and Commercial Services

Environment, Regeneration & Resources
 Corporate Director: Scott Alan BSc., C.Eng., M.I.C.E.

Municipal Buildings
 Clyde Square
 Greenock
 PA15 1LY
 Tel: 01475 712712
 Fax: 01475 712731
 scott.alan@inverclyde.gov.uk

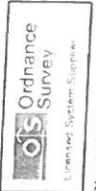
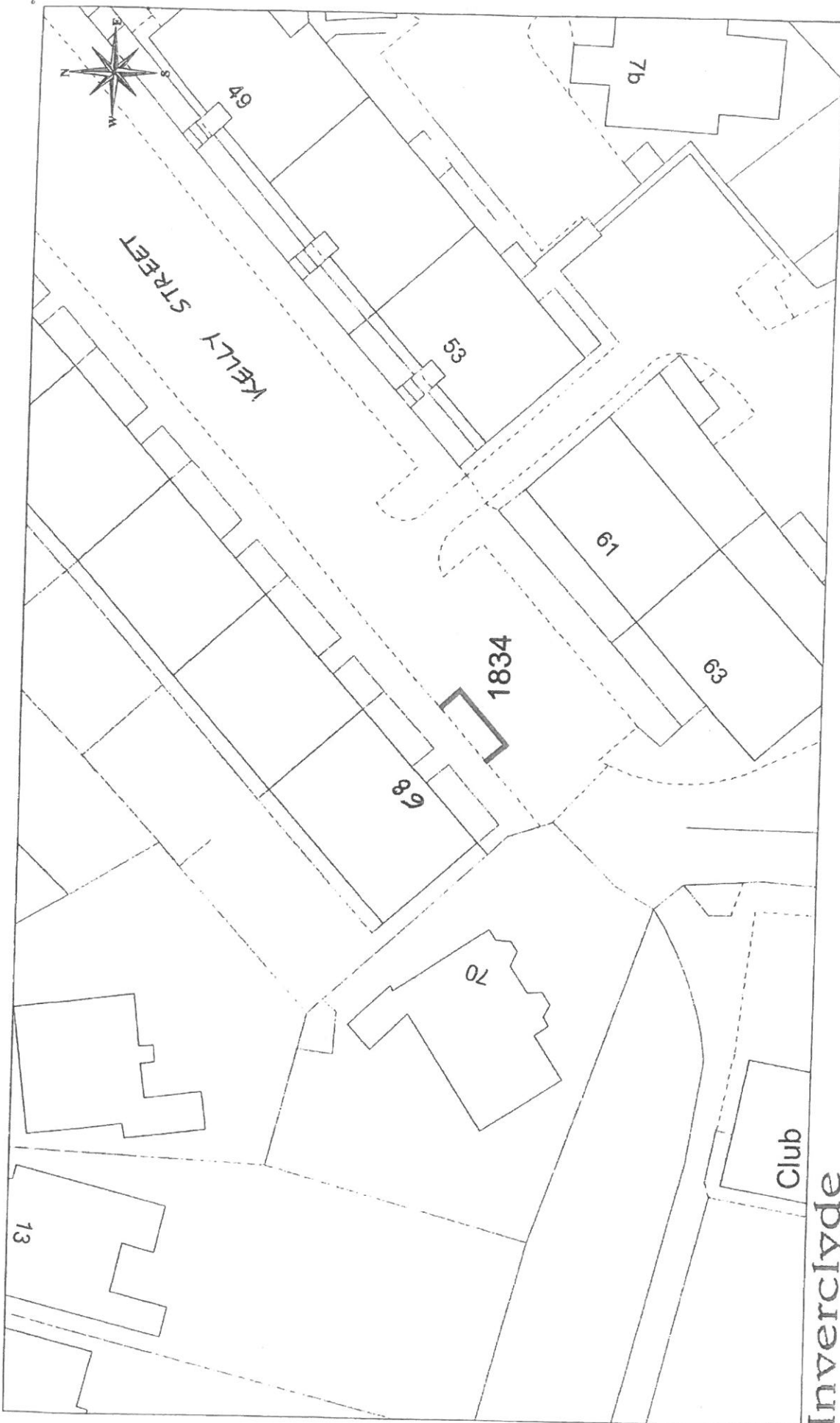

This material has been reproduced from
Ordnance Survey data made available with
the permission of the Controller of
Her Majesty's Stationery Office.
© Crown Copyright

DISABLED PERSONS' PARKING PLACE
68 KELLY STREET, GREENOCK
PLACE No. 1834

Inverclyde
council

Environmental and Commercial Services
 Environment, Regeneration & Resources
 Corporate Director: Scott Allan BSc., C.Eng., M.I.C.E.
 Municipal Buildings
 Clyde Square
 Greenock
 PA15 1LY
 Tel: 01475 712712
 Fax: 01475 712731
 scott.allan@inverclyde.gov.uk

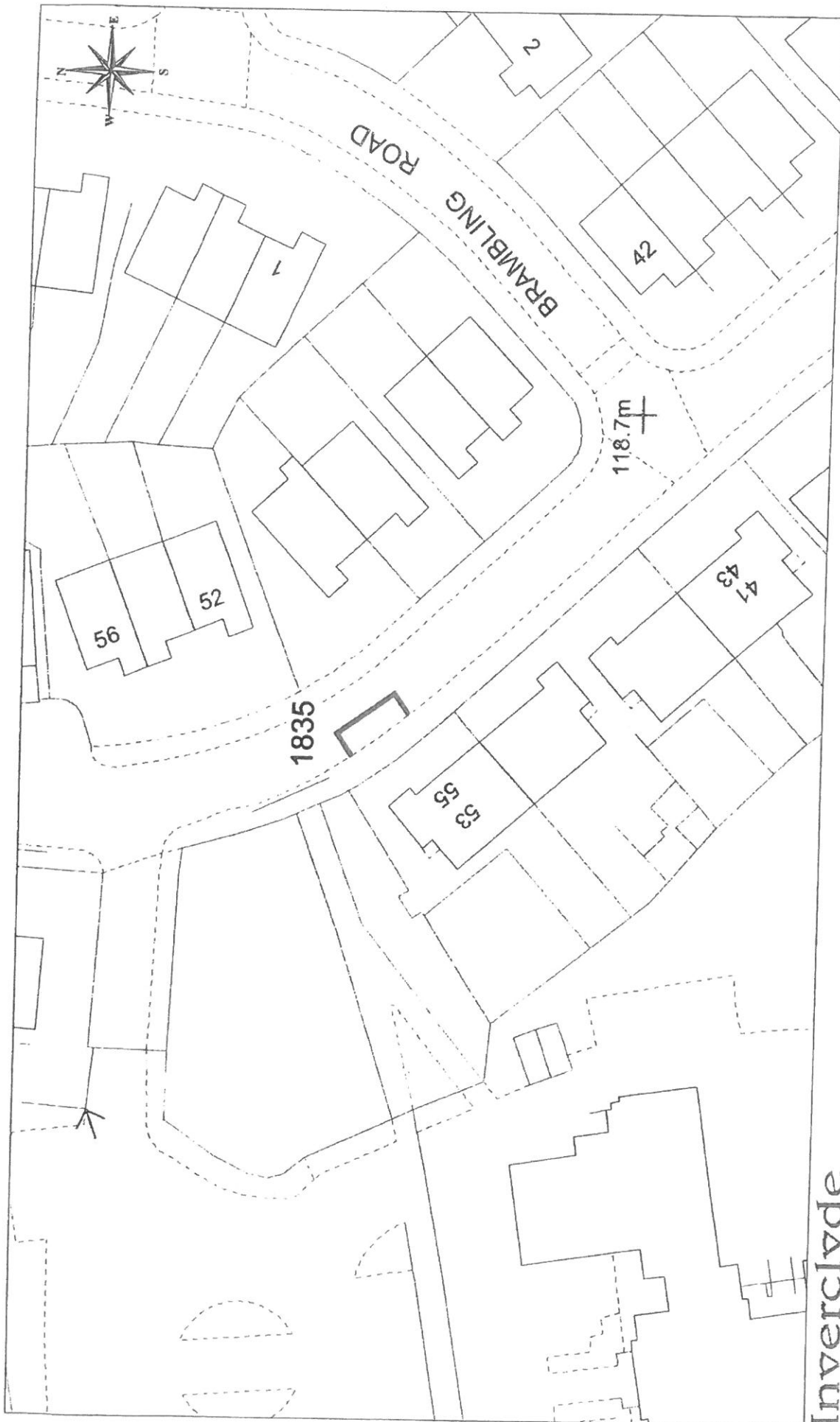

This material has been reproduced from Ordnance Survey data with the permission of Her Majesty's Stationery Office. © Crown Copyright.

DISABLED PERSONS' PARKING PLACE
55 WREN ROAD, GREENOCK
PLACE No. 1835

Inverclyde council
 Environment | and Commercial Services

Environment, Regeneration & Resources
 Corporate Director: Scott Allan BSc., C.Eng., M.I.C.E.
 Municipal Buildings
 Civic Square
 Greenock
 PA15 1LY
 Tel: 01475 712712
 Fax: 01475 712731
 scott.allan@inverclyde.gov.uk

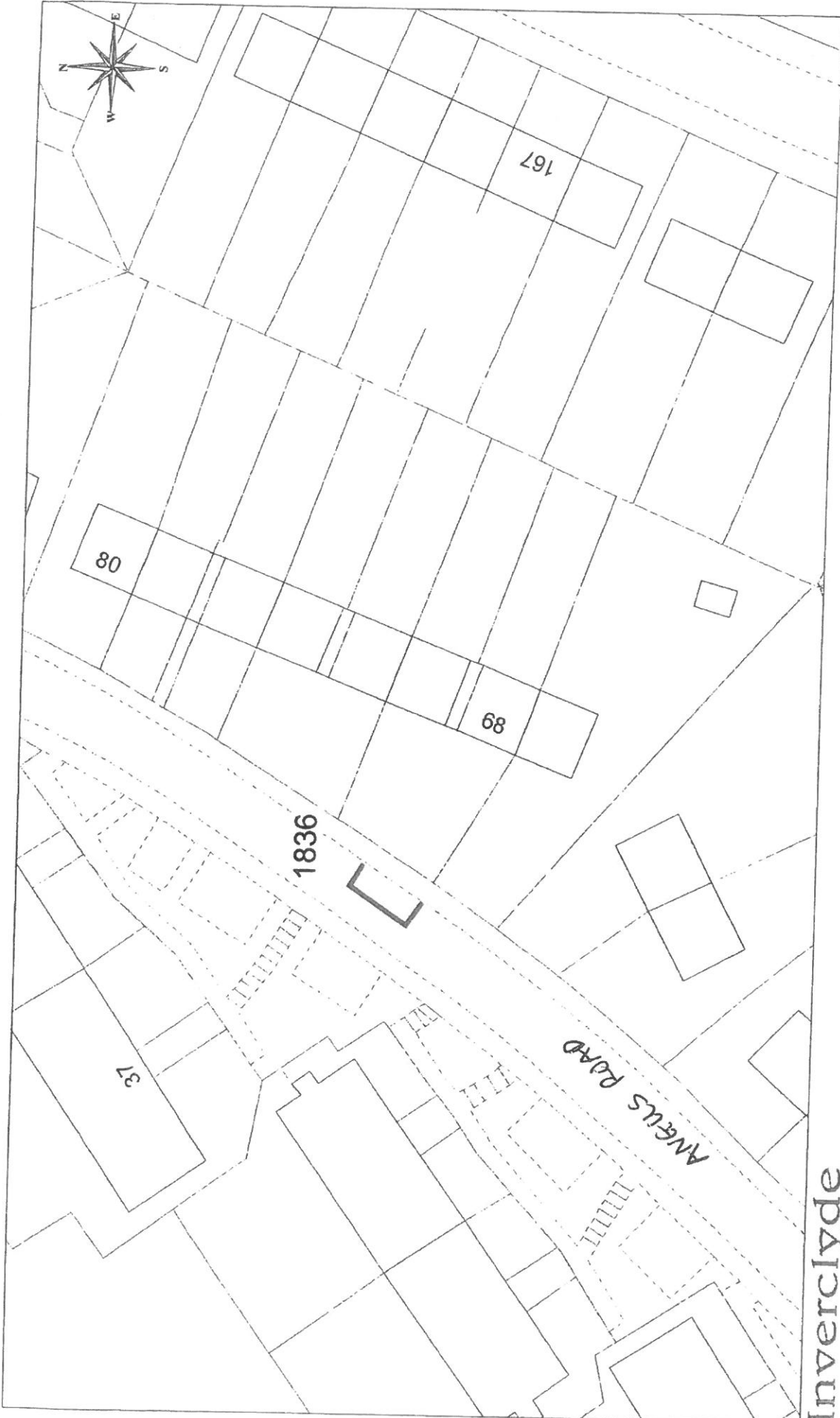

Inverclyde
council

Environmental and Commercial Services

Environment, Regeneration & Resources
Corporate Director: Scott Allan BSc., C.Eng., M.I.C.E

Municipal Buildings
Clyde Square
Greenock
PA15 1LY
Tel: 01475 712712
Fax: 01475 712731
scott.allan@inverclyde.gov.uk

DISABLED PERSONS' PARKING PLACE
68 ANGUS ROAD, GREENOCK
PLACE No. 1836

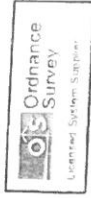

This material has been reproduced from
Ordnance Survey data in accordance with
the Ordnance Survey License of 2003
© Crown copyright

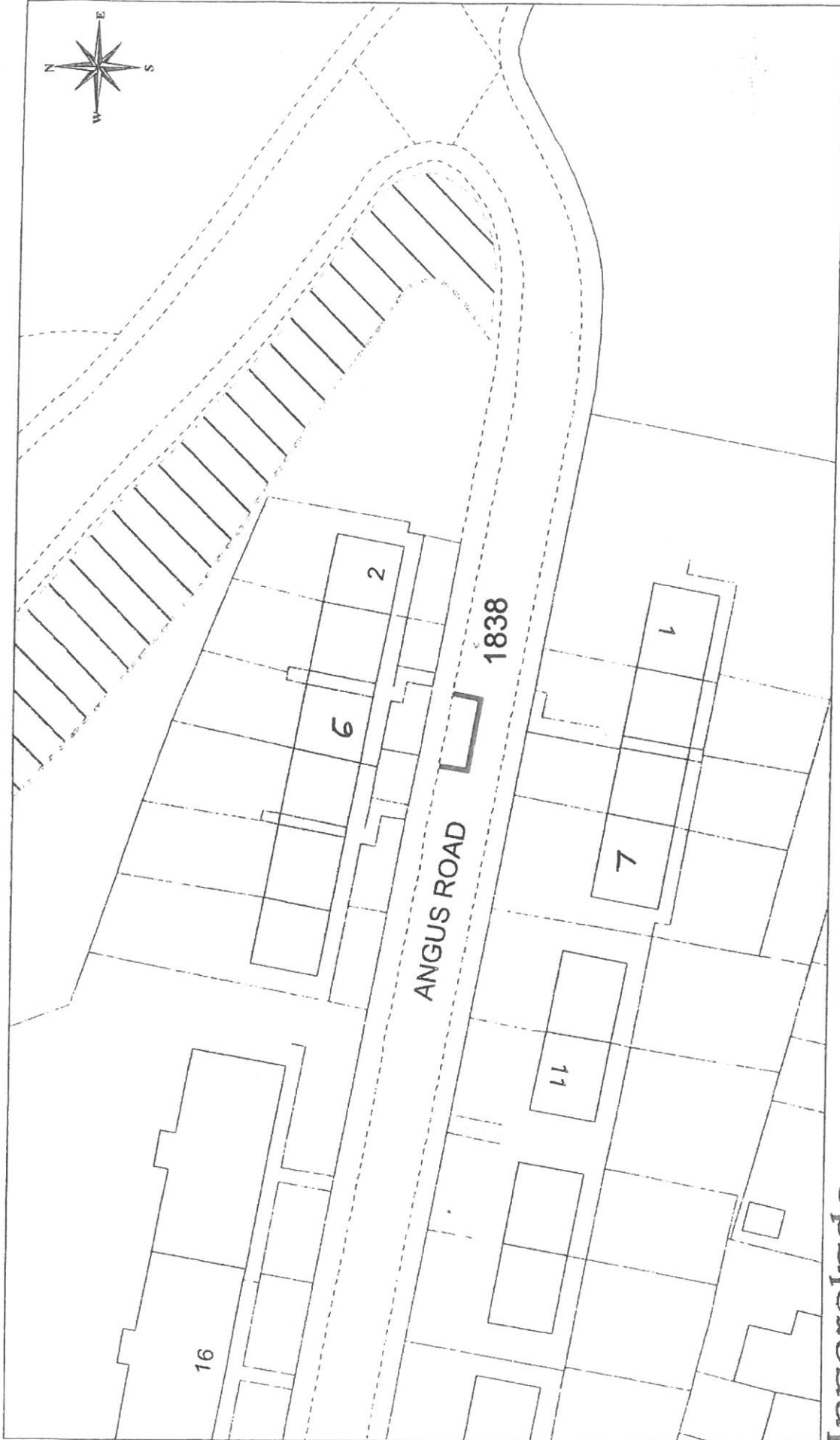

This material has been reproduced from the Ordnance Survey archive with the permission of the Controller of Her Majesty's Stationery Office.

Inverclyde Council
 Environmental and Commercial Services

Environment, Regeneration & Resources
 Corporate Director: Scott Allan BSc., C.Eng., M.I.C.E.
 Municipal Buildings
 Clyde Square
 Greenock
 PA15 1LY
 Tel: 01475 712712
 Fax: 01475 712731
 scott.allan@inverclyde.gov.uk

DISABLED PERSONS' PARKING PLACE
6 ANGUS ROAD, PORT GLASGOW
PLACE No. 1838

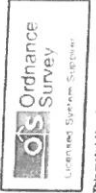
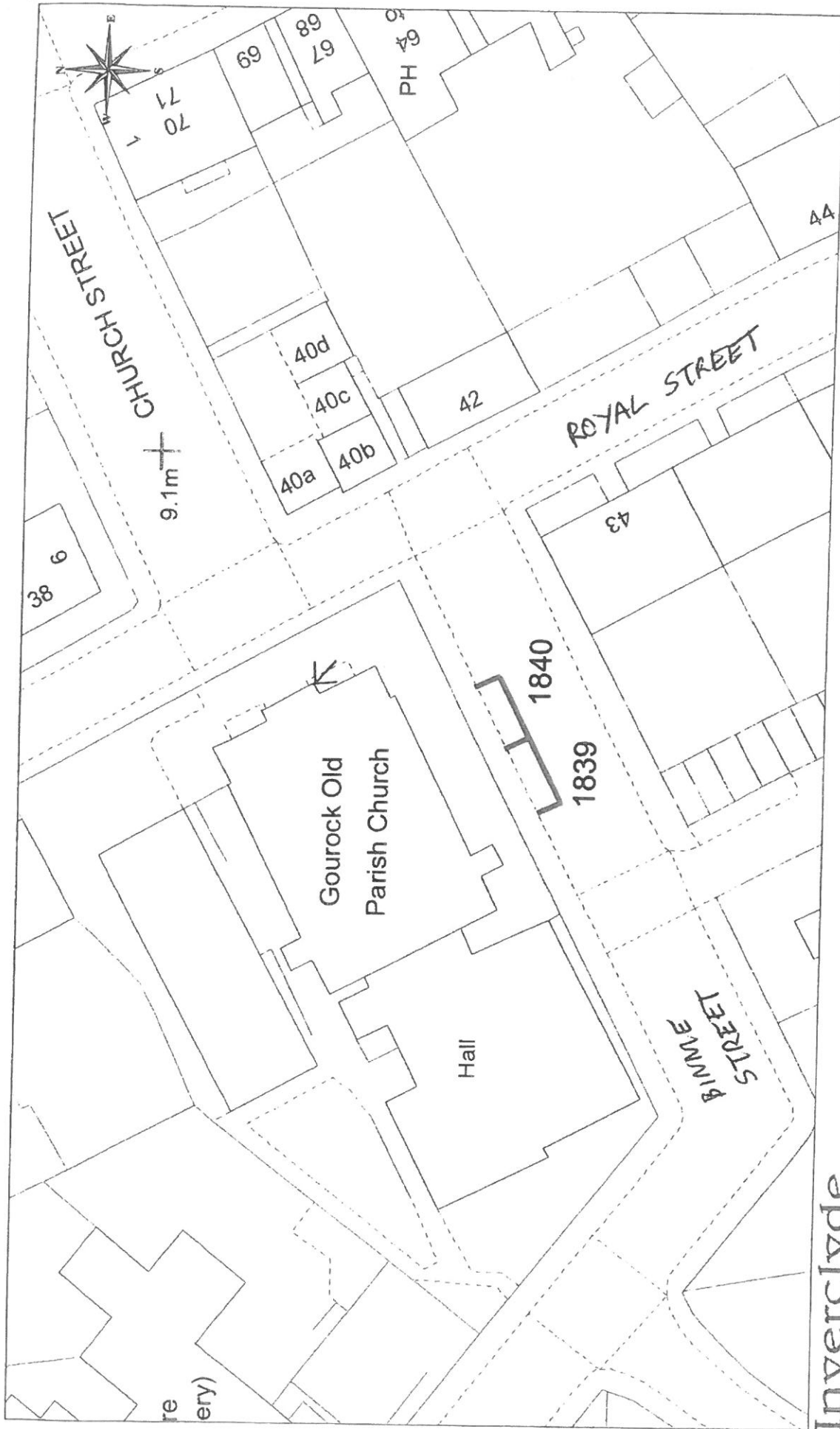

This material has been reproduced from the Ordnance Survey digital map data with the permission of Ordnance Survey under licence at Her Majesty's Stationery Office.
© Crown Copyright

**DISABLED PERSONS' PARKING PLACE
BINNIE STREET, GOUROCK
PLACES Nos. 1839 & 1840**

Inverclyde Council

Environmental and Commercial Services

Environment, Regeneration & Resources
Corporate Director: Scott Alan BSc., C.Eng., M.I.C.E.

Municipal Buildings
Gourock Square
Gourock
PA15 1LY
Tel: 01475 712712
Fax: 01475 712731
scott.alan@inverclyde.gov.uk

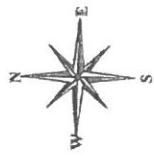

This material has been reproduced from Ordnance Survey digital map data with the permission of the Controller of Her Majesty's Stationery Office. © Crown copyright. Licence Number: 10003421

DISABLED PERSONS' PARKING PLACE
BURNS ROAD, GREENOCK
PLACE No. 1841

Inverclyde
council

Environmental and Commercial Services
 Environment, Regeneration & Resources
 Corporate Director, Scott Allan BSc., C.Eng., M.I.C.E.
 Municipal Buildings
 Clyde Square
 Greenock
 PA15 1LY
 Tel: 01475 712719
 Fax: 01475 712724
 scott.allan@inverclyde.gov.uk

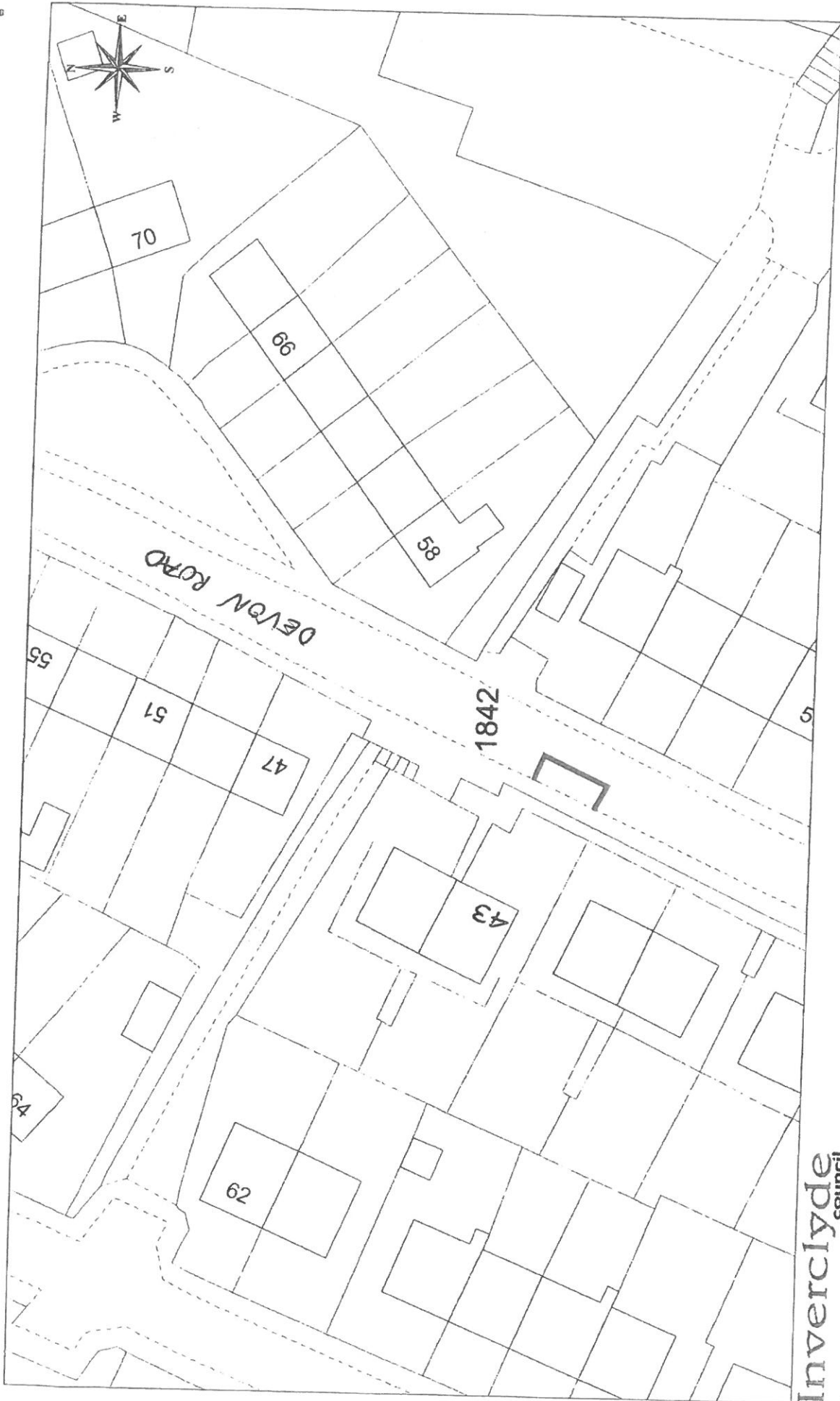

This map has been reproduced from the Ordnance Survey with the permission of the Controller of Her Majesty's Stationery Office.
© Crown copyright.

DISABLED PERSONS' PARKING PLACE
43 DEVON ROAD, GREENOCK
PLACE No. 1842

Inverclyde
council

Environmental and Commercial Services

Environment, Regeneration & Resources
 Corporate Director: Scott Allan BSc., C.Eng., M.I.C.E.

Municipal Buildings
 Cycle Square
 Greenock
 PA15 1LY
 Tel: 01475 712712
 Fax: 01475 712731
 scott.allan@inverclyde.gov.uk

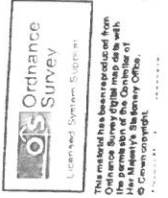
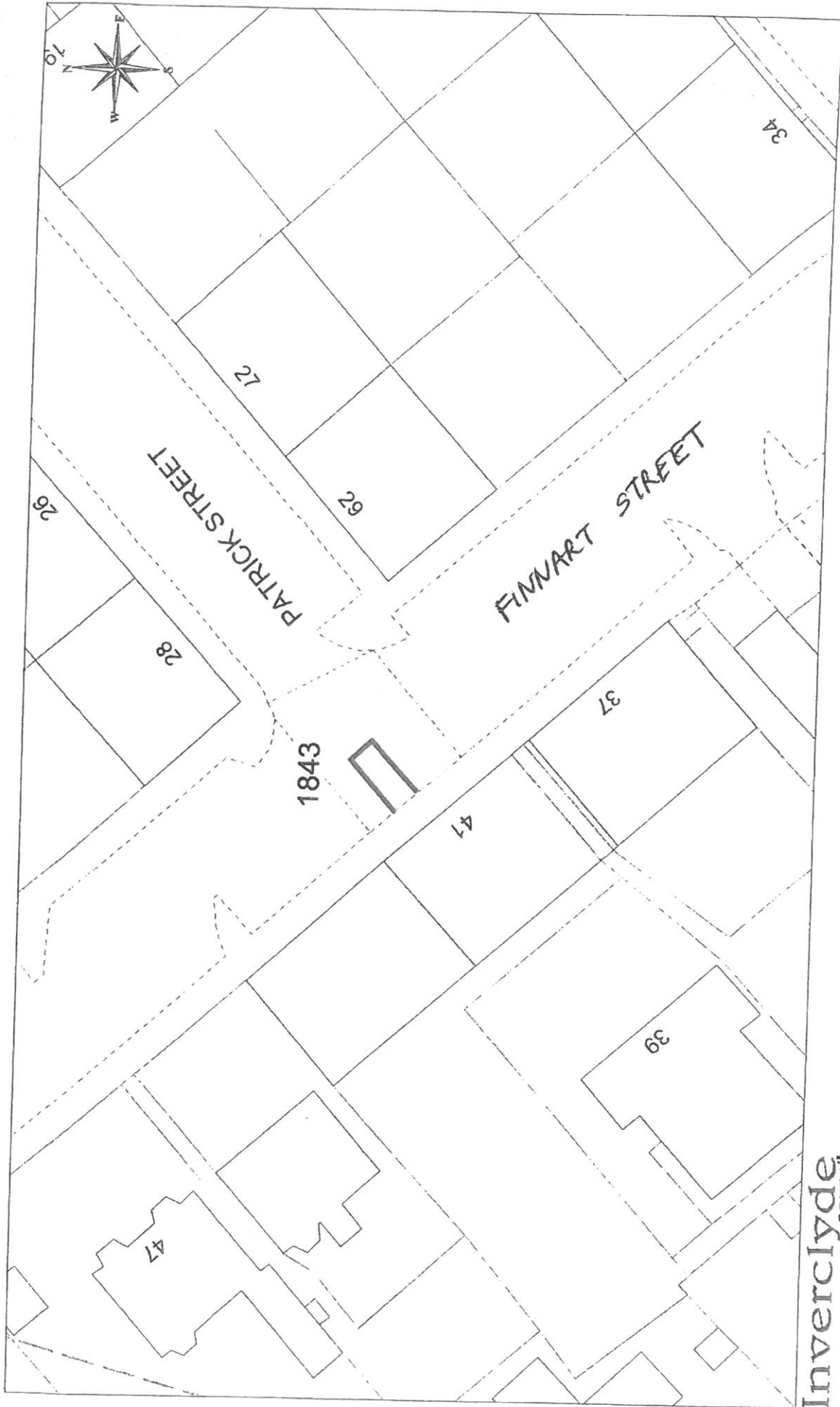

DISABLED PERSONS' PARKING PLACE
 41 FINNART STREET, GREENOCK
 PLACE NO. 1843

Inverclyde
 Council

Environmental and Commercial Services
 Environment, Regeneration & Resources
 Corporate Director Scott Allen BSc., C.Eng., M.I.C.E.
 Municipal Buildings
 Greenock
 PA15 1LY
 Tel: 01475 712712
 Fax: 01475 712731
 scott.allan@inverclyde.gov.uk

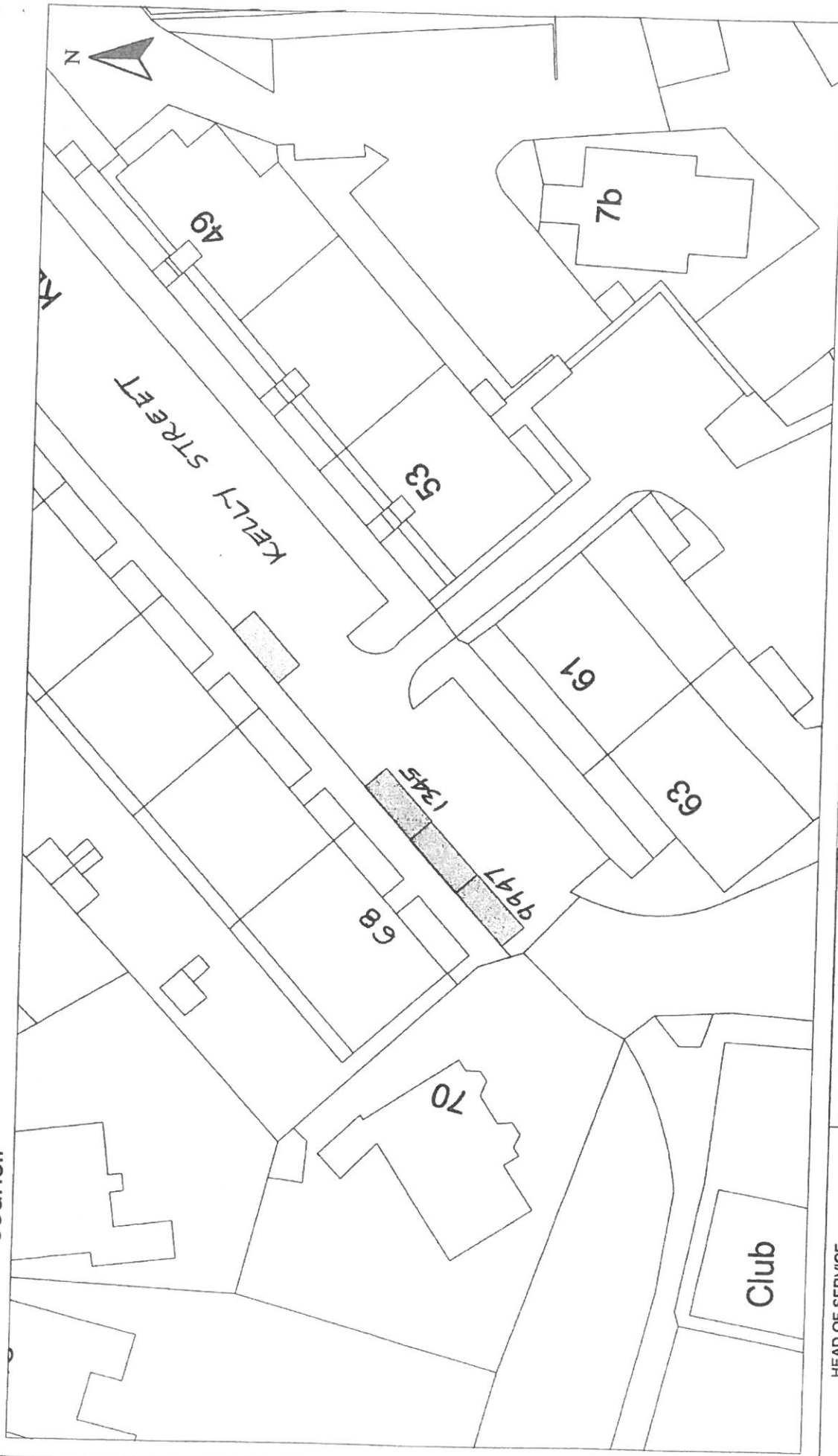

HEAD OF SERVICE
IAN MOFFAT

71 EAST HAMILTON STREET
GREENOCK, PA15 2UA

Disabled Bays

Reproduced from Ordnance Survey mapping with the permission of the Controller of Her Majesty's Stationery Office. Crown Copyright. Unauthorised reproduction is prohibited. Crown Copyright and may result in prosecution or legal proceedings.

Licence No. LA03097L



DISABLED PERSONS' PARKING PLACE
68 KELLY STREET, GREENOCK
PLACES Nos. 9947 & 1345 REVOCATION

Scale : 1:500

Prepared by : R. MACKAY

Drawn by : R. MACKAY

Drawing No. :

Date : NOV 2013

Checked by :

Approved by :

File No. : 19/12

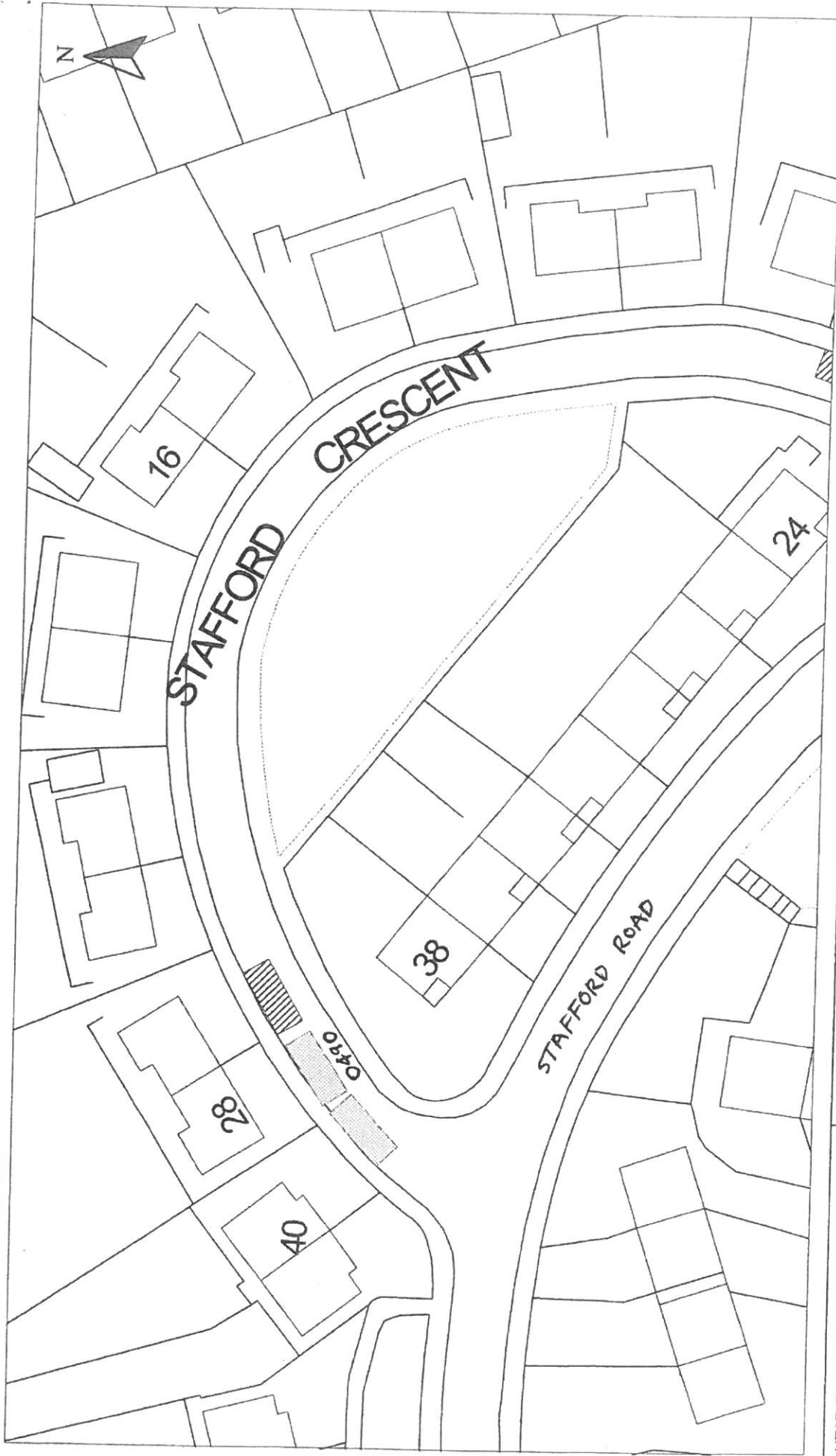

HEAD OF TRANSPORTATION AND ROADS
E. McCARRON C.Eng., M.I.C.E.

Disabled Bays
71 EAST HAMILTON STREET
GREENOCK, PA15 2JA

Reproduced from Ordnance Survey mapping with the permission of the Controller of Her Majesty's Stationery Office. Crown Copyright. Unauthorised reproduction infringes Crown Copyright and may result in prosecution or legal proceedings. Licence No. LA03097L

DISABLED PERSONS' PARKING PLACE
28 STAFFORD CRESCENT, GREENOCK
PLACE No. 0490 REVOCATION

Scale :	1:500	Date :	JULY 2004
Prepared by :	R. MACKAY	Checked by :	
Drawn by :	R. MACKAY	Approved by :	
Drawing No. :		File No. :	19/12



HEAD OF PLANNING AND TRANSPORTATION
F. K. WILLIAMSON

Disabled Bays
6 CATHCART SQUARE
GREENOCK, PA15 1LS

Reproduced from Ordnance Survey mapping with the permission of the Controller of Her Majesty's Stationery Office. Crown Copyright. Unauthorised reproduction infringes Crown Copyright and may result in prosecution or legal proceedings.

Licence No. 1000023421



DISABLED PERSONS' PARKING PLACE
7 & 9 MORRIS STREET, GREENOCK
PLACES Nos. 0732 & 0737 REVOCATION

Scale : 1:500

Prepared by : R. MACKAY

Drawn by : R. MACKAY

Drawing No. :

Date : SEPT 2007

Checked by :

Approved by :

File No. : 19/12

Inverclyde
council

PLANNING, HOUSING AND TRANSPORTATION



Blairfield

HEAD OF PLANNING, HOUSING AND
TRANSPORTATION :- F. K. WILLIAMSON

Disabled Bays
6 CATHCART SQUARE
GREENOCK, PA15 1LS

Reproduced from Ordnance Survey mapping with the permission
of the Controller of Her Majesty's Stationery Office. Crown
Copyright. Unauthorised reproduction infringes Crown Copyright
and may result in prosecution or legal proceedings.

Licence No. 100022421
(2008)



DISABLED PERSONS' PARKING PLACE
2 MALLARD CRESCENT, GREENOCK
PLACE No. 0822 REVOCATION

Scale : 1:500

Prepared by : R. MACKAY

Drawn by : R. MACKAY

Drawing No. :

Date : MAY 2008

Checked by :

Approved by :

File No. : 19/12

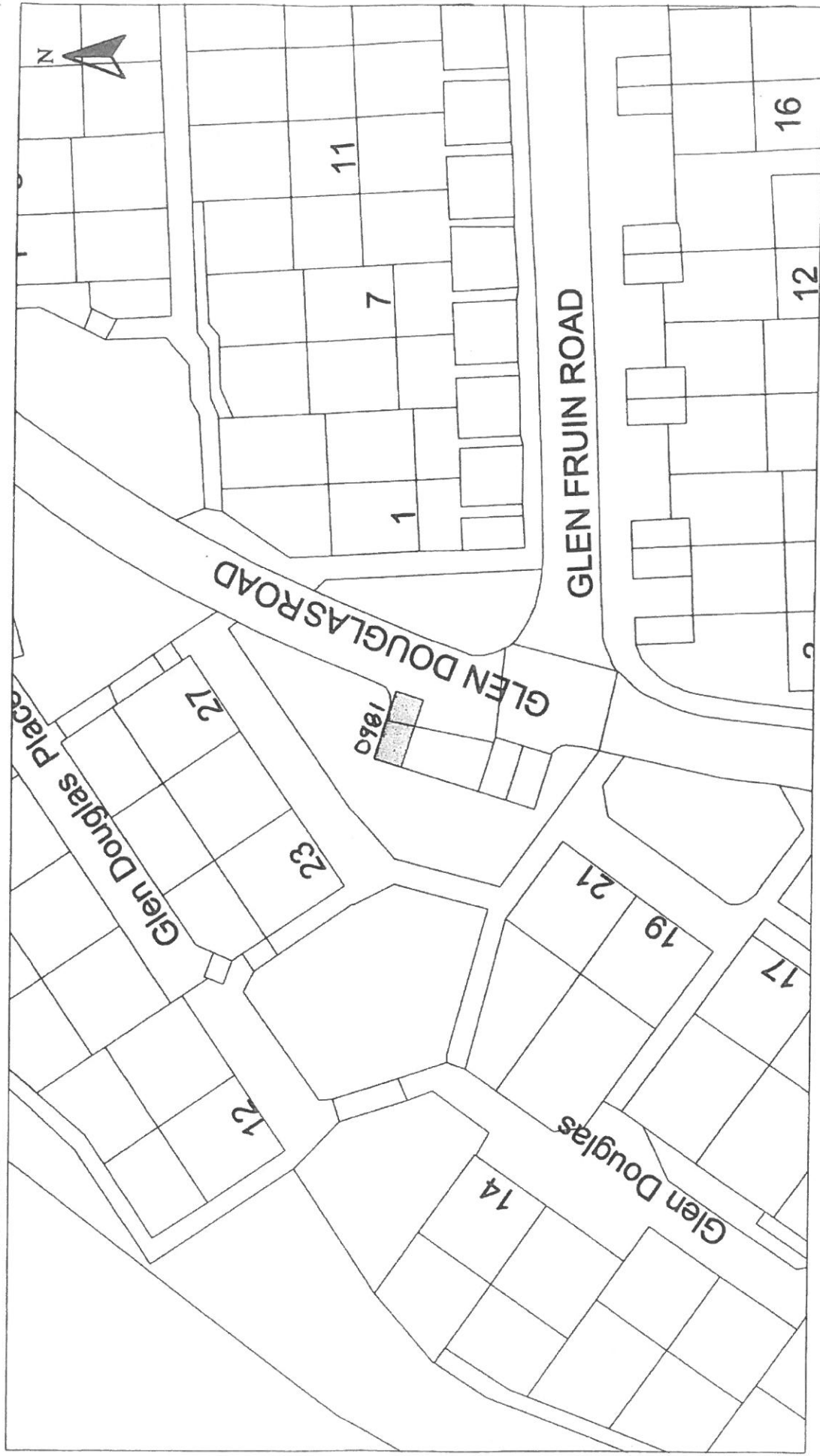

<p>HEAD OF SERVICE ALAN G BARNES MCIWM CERV</p>	<p>DISABLED PERSONS' PARKING PLACE 27 GLEN DOUGLAS ROAD, GREENOCK PLACE No. 0981 REVOCATION</p>	<p>Scale : 1:500 Prepared by : R. MACKAY Drawn by : R. MACKAY Date : JULY 2010 Checked by : Approved by : File No. : 19/12</p>
<p>Disabled Bays</p>	<p>71 EAST HAMILTON STREET GREENOCK, PA15 2JA</p>	<p>Reproduced from Ordnance Survey mapping with the permission of Ordnance Survey. Copyright © Crown Copyright. Unauthorised reproduction is prohibited and may result in prosecution or legal proceedings. Licence No. LA03097L Ordnance Survey</p>

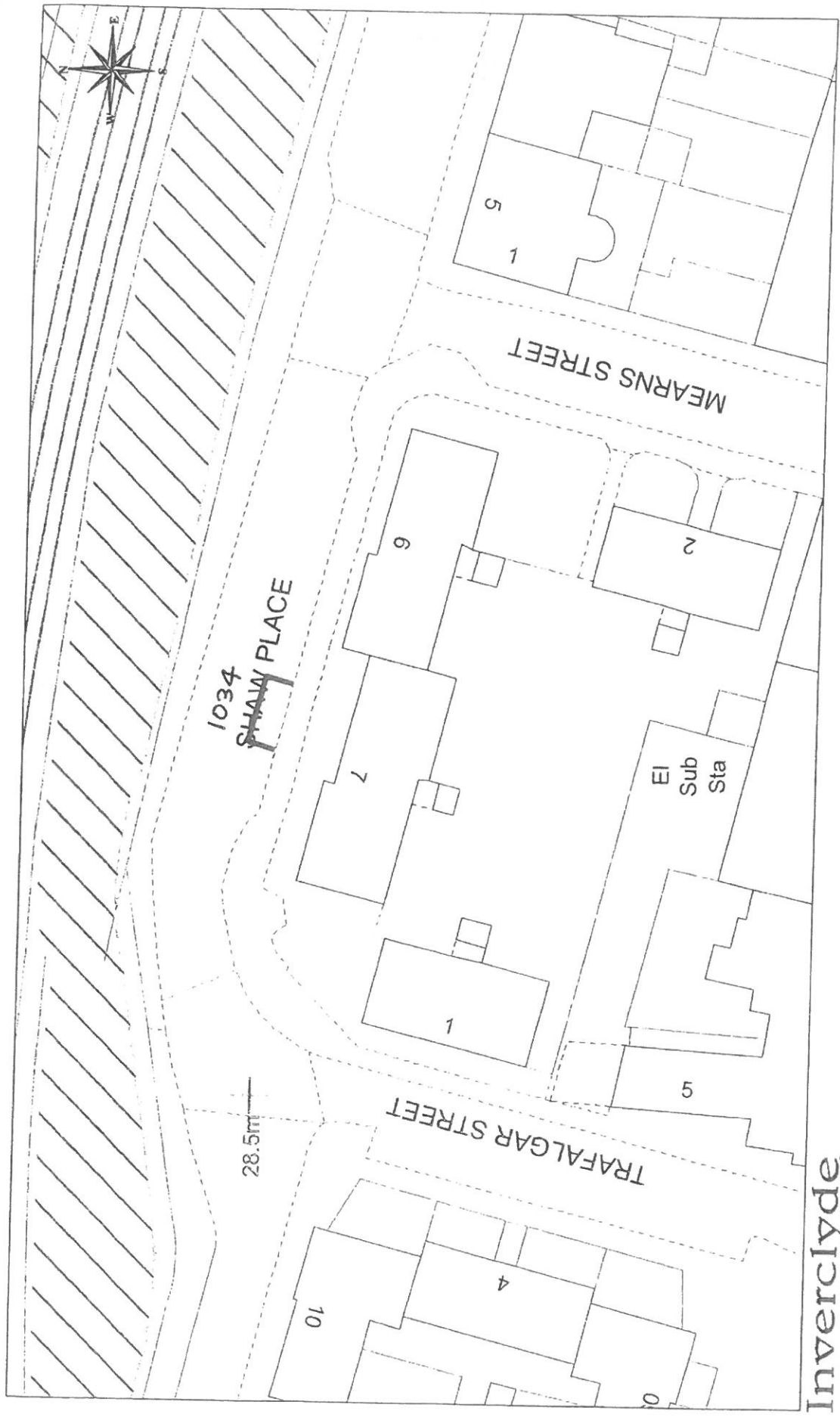

Ordnance Survey
 Licensed System Supplier
 This plan has been approved for use in accordance with the provisions of the Ordnance Survey Act 2003 by the Controller of Her Majesty's Stationery Office.
 License Number: 100029471

DISABLED PERSONS' PARKING PLACE
7C SHAW PLACE, GREENOCK
PLACE No. 1034 REVOCATION

Inverclyde Council
 Environmental and Commercial Services
 Environment, Regeneration & Resources
 Corporate Director, Scott Alan BSc., C.Eng., M.I.C.E.
 Municipal Buildings
 Cycle Square
 Greenock
 PA15 1LY
 Tel: 01475 712712
 Fax: 01475 712731
 ecouncil@inverclyde.gov.uk

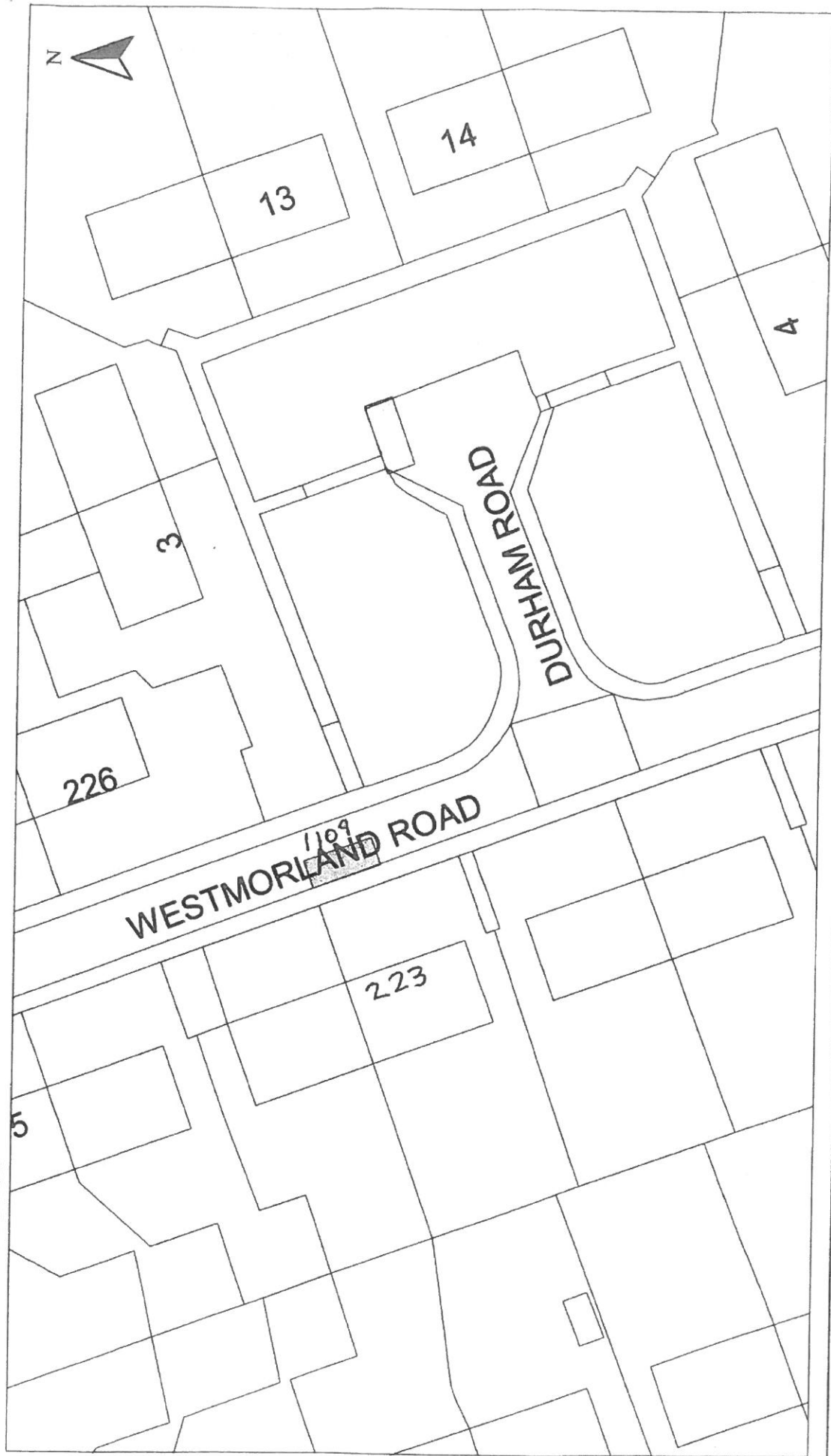

<p>HEAD OF SERVICE IAN MOFFAT</p>	<p>Scale : 1:500</p>	<p>Date : APR 2011</p>
<p>71 EAST HAMILTON STREET GREENOCK, PA15 2UA</p>	<p>Prepared by : R. MACKAY Drawn by : R. MACKAY Drawing No. : 19/12</p>	<p>Checked by : Approved by : File No. : 19/12</p>
<p>DISABLED PERSONS' PARKING PLACE 223 WESTMORLAND ROAD, GREENOCK PLACE No. 1109 REVOCATION</p> <p><small>Reproduced from Ordnance Survey maps by the permission of the Controller of Her Majesty's Stationery Office. Copyright. Unauthorised reproduction infringes Crown Copyright and may result in prosecution or legal proceedings.</small></p> <p><small>License No. LA03067L</small></p> 		

Disabled Bays

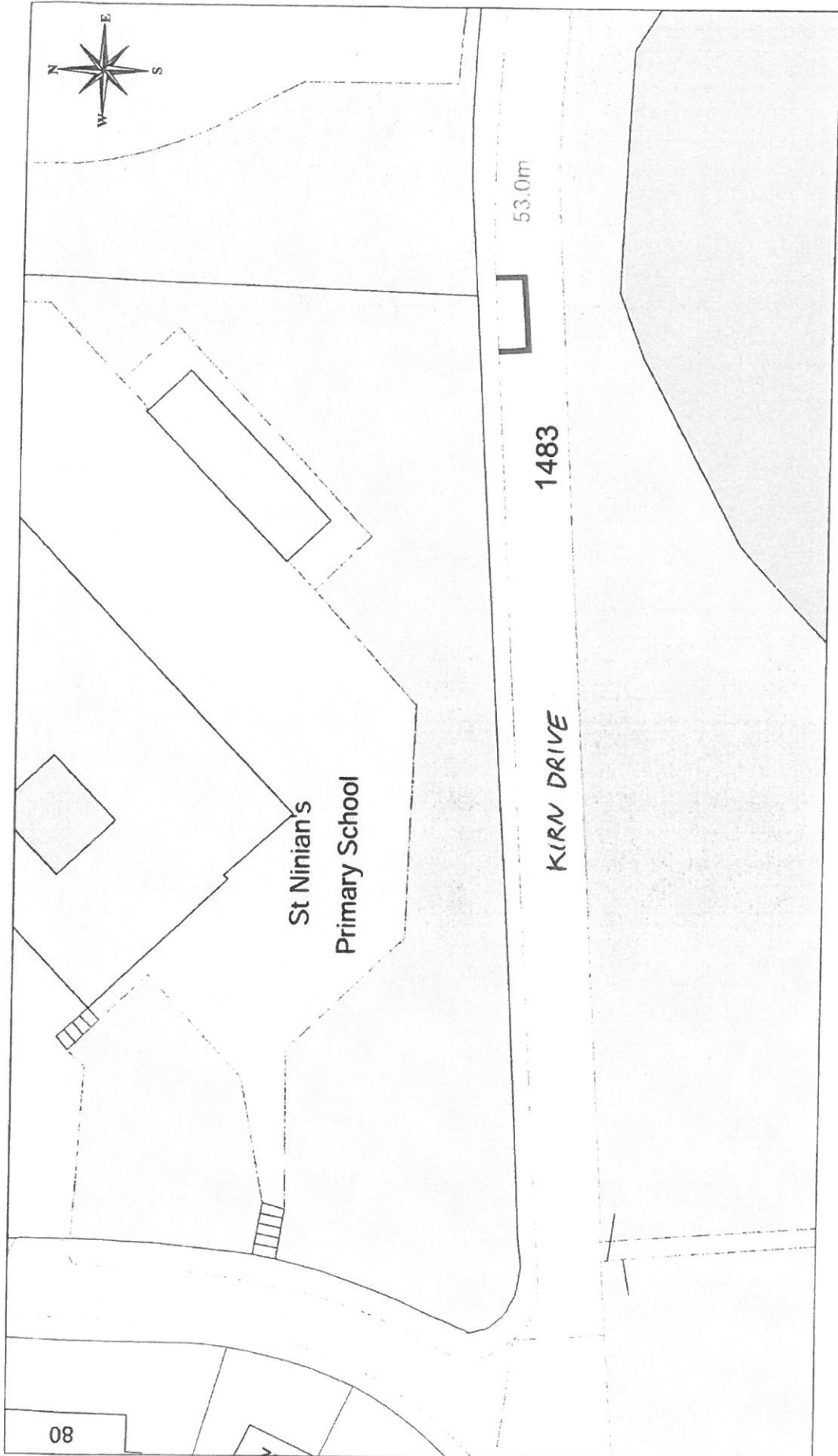

This material has been reproduced from the Ordnance Survey digital map data with the permission of the Ordnance Survey, Her Majesty's Stationery Office.
 Licence Number: 100723421

Inverclyde
 council
 Environmental Services

Regeneration & Environment
 Corporate Director: Aubrey Fawcett
 Municipal Buildings
 Clyde Square
 Greenock
 PA15 1LY
 Tel: 01475 712712
 Fax: 01475 712731
 aubrey.fawcett@inverclyde.gov.uk

DISABLED PERSONS' PARKING PLACE
 KIRN DRIVE, GOUROCK
 PLACE No. 1483 REVOCATION

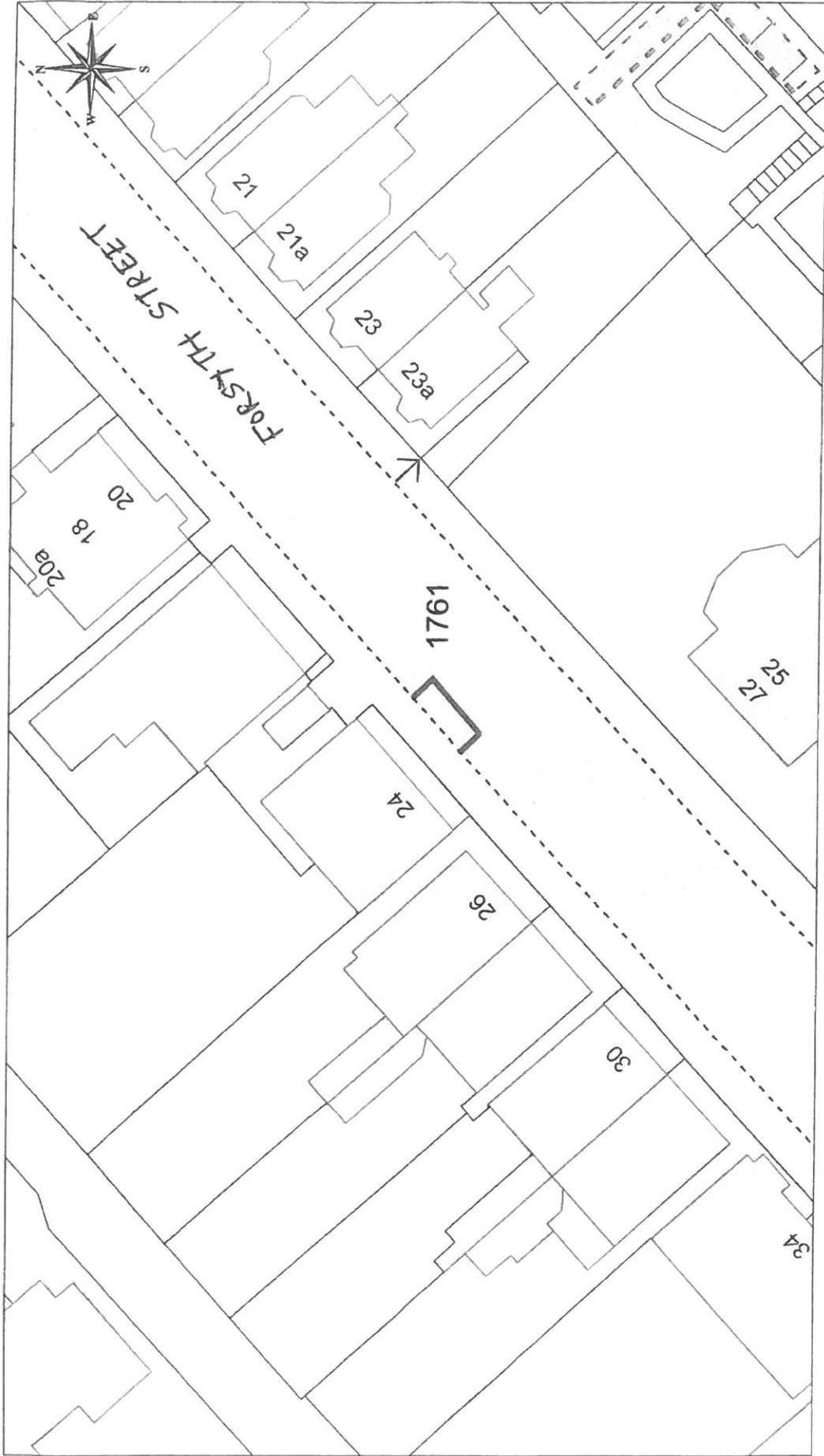

This material has been reproduced from
Ordnance Survey (OS) data made available
under the terms of the Ordnance Survey
OpenMap Licence. © Crown copyright.
Licence Number: 1000431

**DISABLED PERSONS' PARKING PLACE
24 FORSYTH STREET, GREENOCK
PLACE No. 1761 REVOCATION**

Inverclyde
council
Environmental Services

Regeneration & Environment
Corporate Director: Aubrey Fawcett
Municipal Buildings
Childe Square
Greenock
PA15 1LY
Tel: 01475 712712
Fax: 01475 712731
aubrey.fawcett@inverclyde.gov.uk

THE INVERCLYDE COUNCIL

**DISABLED PERSONS' PARKING PLACES
(ON-STREET) ORDER NO. 4 2018**

**Statement of Reasons for Proposing to Make
the above Order**

It is considered necessary in order to comply with Section 5 of The Disabled Persons' Parking Places (Scotland) Act 2009, to make the above Order to provide assistance for disabled persons who hold a badge under the Disabled Persons (Badges for Motor Vehicles) (Scotland) Regulations 2000 as amended and to revoke those parking places no longer required to maximise street parking capacity.

Martin McNab
Head of Environmental & Public Protection
8 Pottery Street
GREENOCK
PA15 4UE